

9707 100 20660 --- E-BHWSO 2500-2 --- WSO 2500-2

Functional Description

- Slope down conveyor 7° (second segment)
- Micro chain instead of Belt Track
- Buffer 2 pcs of PCB's
- Controlled by P.L.C.
- Communication via SMEMA standard
- DC motor control board for var. belt speed
- High/ Low speed control at first segment
- Hand crank width adjustment

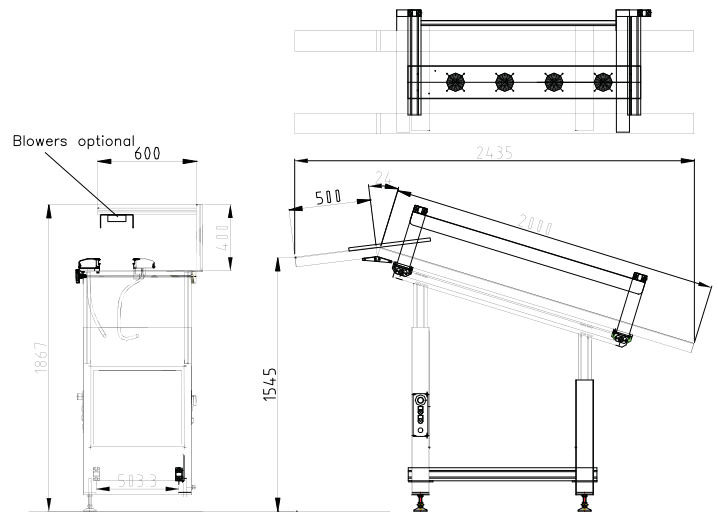

General Module Specifications

Module L/W/H	: 2435 / 755 / 867 mm
Belt segment	: 2
Transport height (inf):	±1500 mm +35/-25mm
Transport height (outf):	930 mm +35/-25mm
Transport width	: 50-460mm
Transport speed	: 15 meter / minute
Transport direction	: Left to Right
Fixed rail	: Front facing from operator side
Control	: OMRON PLC
Motor control	: Motor Control Board
Operation	: Push Buttons
Software	: Syswin
Colour	: Ral 9002
Power consumption	: 300 Watt
Power requirements	: 230V, 50Hz, single phase with ground
Cables & wiring	: According NEN-EN 60204-1
Weight	: 110 kg

General PCB Specifications

PCB Width	: 50 to 460 mm
PCB Thickness	: 0,6 to 1 mm (to be discussed)
PCB Thickness	: 1 to 3 mm
PCB Length	: 100 to 460 mm
PCB Length/width ratio	: minimum 8:10
PCB Warpage	: Up to 1% of the boards diagonal with a max. of 4mm
Transport edge	: min. 3mm from board edge
Max. comp. height	: 50 mm for top & bottom side
Maximum. weight	: 2,3 Kg

