



Key features

- Separates PWB modules from the panel
- Accurate and clean cut
- Built in multi language support
- Easy and precise cell teaching

Maxirouter J501-45

Maxirouter J501-45

Standard Features

- Tooling pins for PWB positioning
- Upper and lower CNC robot
- Product milling from bottom side
- Product handling by manipulator
- Product flow direction from left to right
- Cutting tool breakage control
- Pneumatic milling tool change
- HF-motor spindle and converter
- DXF file support for teaching cutting points
- Camera for teaching cutting points
- Graphical user interface
- ESD-safe design
- CE-safety compliant

Technical Characteristics

- Machine dimensions (L x D x H):
 - 1280 x 2000 x 2300 mm (50" x 79" x 90") (with beacon)
 - Weight of router and external vacuum cleaner approx. 1600 kg (3526 lbs)
- Input conveyor
 - Edge conveyor, narrow flat belts
 - Width 50...470 mm (2"...18.5")
 - Width adjustment automatically
- Output conveyor
 - Flat belt conveyor
 - Width 250 or 400 mm (9.8" or 15.7")
- Conveyor height 950 mm ±25 mm (37.4" ± 1")
- Spindle speed 5000-50000 rpm

- Chuck diameter 3.175 mm (1/8")
- Cutting speed up to 45 mm/s (1.8"/s) depends on product and milling bit
- Product cutting accuracy ±0.15 mm (±0.006")
- Noise level <75dB(A)

Options

- Product specific grippers
- Automatic tool exchange system
- External vacuum cleaner
- Code reader
- Power supply other than specified
- Product flow direction from right to left
- Machine vision
- PWB support from bottom side

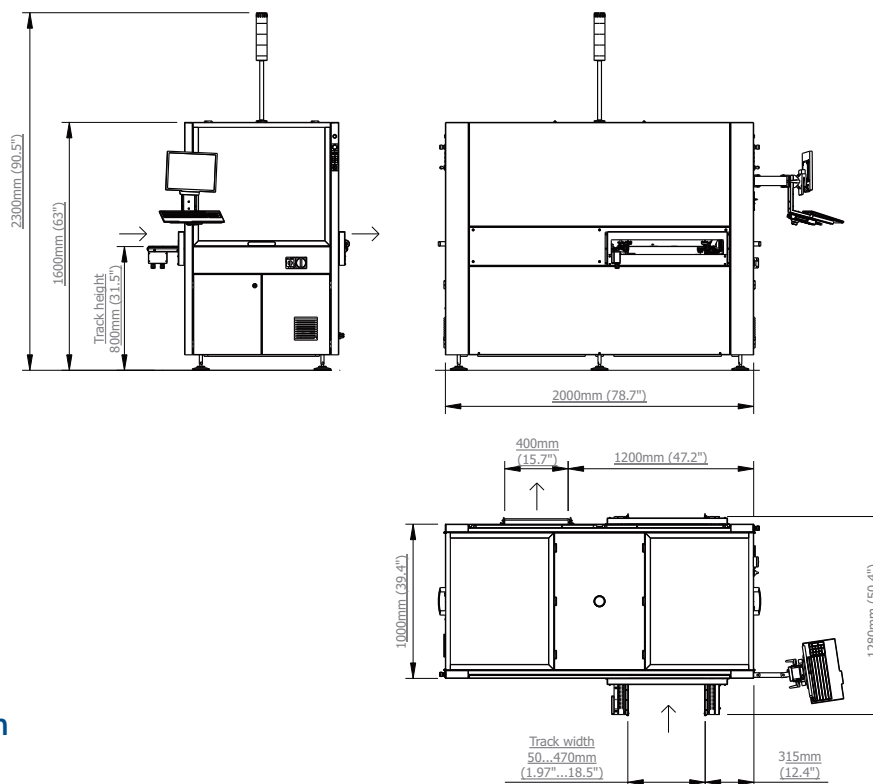

Jot Automation

Paulaharjuntie 20
90530 Oulu
FINLAND

T +358 40 301 5000
F +358 8 57 10 501

info@jotautomation.com
www.jotautomation.com

Installation Requirements

- Power supply: 3P/N/PE, 400 VAC, 50/60 Hz, 16A
- Power consumption: 3 kVA
- Air pressure: 0.6 MPa (6 bar)
- Air consumption: 280 l/min (10 cfm)

Board Specifications

- Material FR4, FR4 with copper layers
- Max. dimensions (W x L): 470 x 470 mm (18.5"x8.5")
- Thickness: 0.4-3.2 mm (0.016"-0.13")
- Weight: 2 kg (4.4 lbs)